

\$339,900 - 131 Hayward Crescent, Edmonton

MLS® #E4442845

\$339,900

0 Bedroom, 0.00 Bathroom,
Single Family on 0.00 Acres

Hodgson, Edmonton, AB

WANT TO BUILD YOUR DREAM HOME IN SW EDMONTON? A VERY RARE OPPORTUNITY ! 34 POCKET WALKOUT LOT available in HODGSON . Hodgson is a beautiful family community in SW Edmonton that has parks, walking trails & borders the ravine. Close to all amenities, Terwillegar Rec Centre, Shopping, Restaurants & Schools.

Essential Information

MLS® #	E4442845
Price	\$339,900
Bathrooms	0.00
Acres	0.00
Type	Single Family
Sub-Type	Vacant Lot/Land
Status	Active

Community Information

Address	131 Hayward Crescent
Area	Edmonton
Subdivision	Hodgson
City	Edmonton
County	ALBERTA
Province	AB
Postal Code	T6R 3G3

Exterior

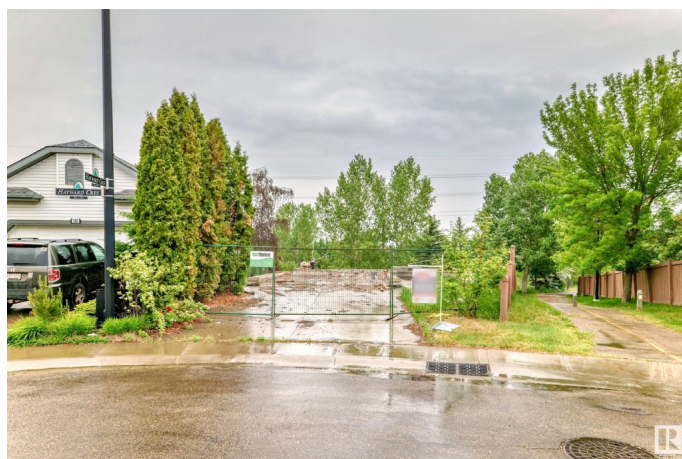
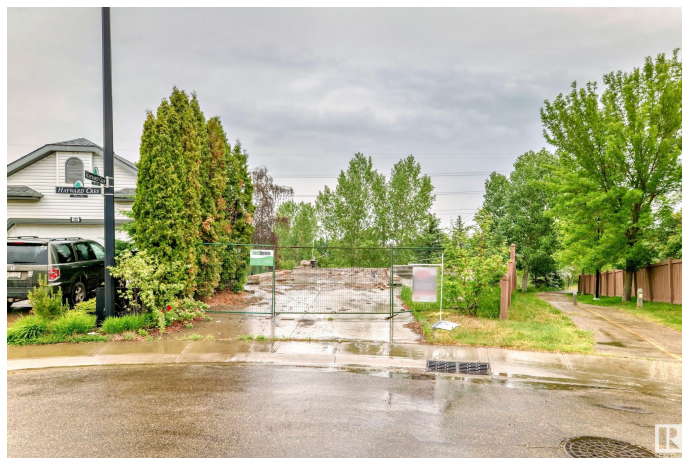

Exterior Features See Remarks

School Information

Elementary	Riverbend Junior High scho
Middle	Riverbend Junior High scho
High	Lillian Osborne High Schoo

Additional Information

Date Listed	June 17th, 2025
Days on Market	26
Zoning	Zone 14

DATA IS DEEMED RELIABLE BUT IS NOT GUARANTEED ACCURATE BY THE REALTORS® ASSOCIATION OF EDMONTON. COPYRIGHT 2025 BY THE REALTORS® ASSOCIATION OF EDMONTON. ALL RIGHTS RESERVED.Trademarks are owned or controlled by the Canadian Real Estate Association (CREA) and identify real estate professionals who are members of CREA (REALTOR®, REALTORS®) and/or the quality of services they provide (MLS®, Multiple Listing Service®)

Listing information last updated on July 13th, 2025 at 4:17am MDT